

VR-8X00-SMB(S)



Quick Guide V 1.02

VR-8X00-SMB(S) DECT master phone

For single Ethernet models

1. Overview

This phone is a full-feature telephone that provides voice communication. Read this QIG carefully to learn how to operate this product and take advantage of its features.

Package Contents

When unpacking the phone, ensure all the following items are present and undamaged. If anything appears to be missing or broken, contact your dealer for a replacement.

1. Cordless Handset
2. Charging Stand
3. Battery
4. AC Adaptor(optional)
5. Quick Installation Guide (This document)

2. Product Description

The following contains important information to help you familiarize with the functions of the phone.

Front View

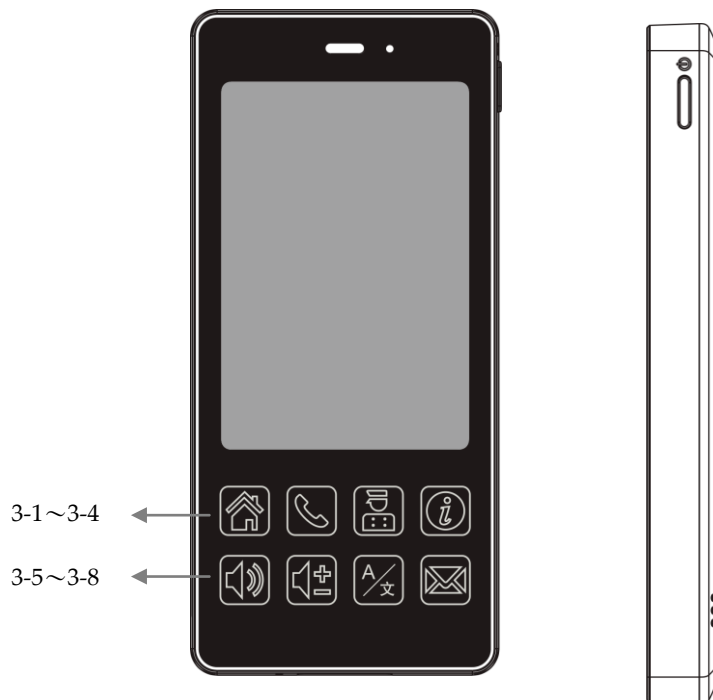

item	Name	Description
1	Display screen	Touchable display
2	Power key	Press to power on/off
3	Function key	
3-1	Home key	Press to return to idle page
3-2	Dial key	Press these keys to enter phone numbers.
3-3	Service key	Press to enter service page.
3-4	Dialing Instruction key	Press to enter Dialing Instructions page.

item	Name	Description
		Red LED turns on when handset is charging, Red LED turns off when handset is fully charged,
3-5	Speaker key	Press to activates the speakerphone for hands free conversations.
3-6	Volume + -	Press to increase or decrease the volume of the ringer tone, handset, or speakerphone.
3-7	Language key	Press to select display language
3-8	Message key	Press to listen to voice messages. Red LED turns on while there is unheard voice message.

Rear view

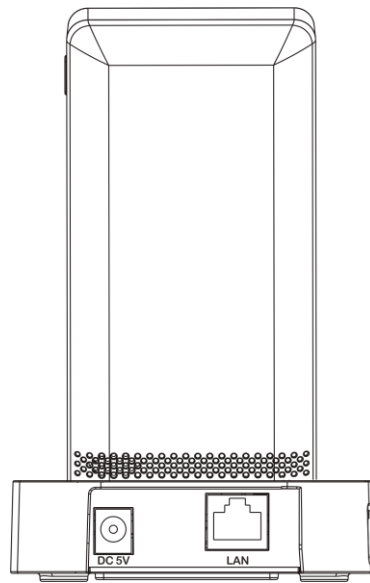

Name	Description
DC jack	Connects to AC power adapter.
LAN port	Connects to HUB, ADSL, or Switch(PSE)

Side view

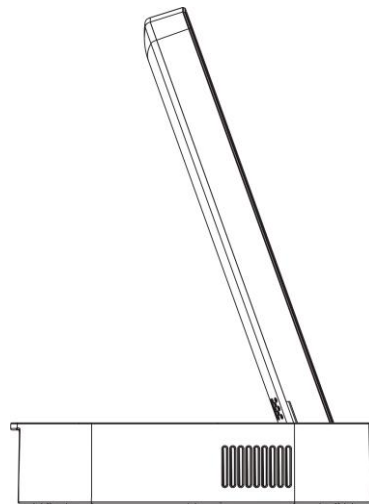

Bottom view

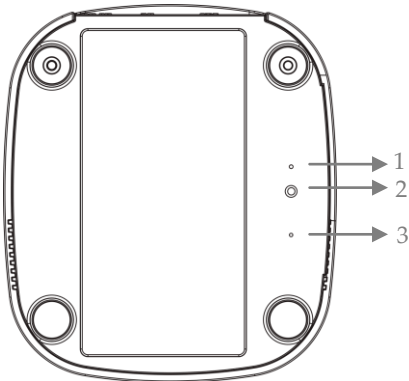



Item	Name	Description
1	Debug LED	Debug LED
2	Handset search button	To search handset
3	Reset	Press to reset DECT base station.

Battery Installation

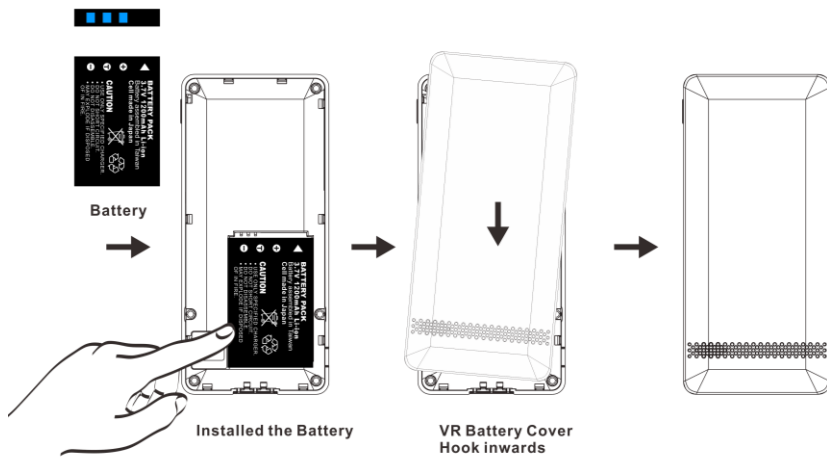
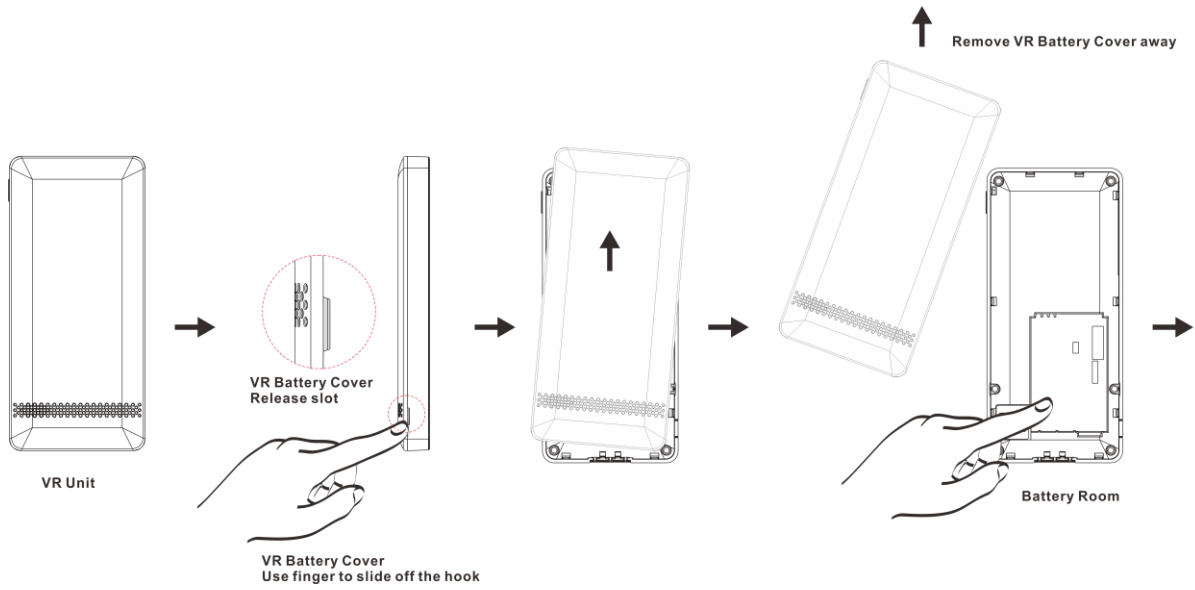
The following illustration shows how to install the handset and battery.



3. Phone setup

At dialing page , press [****6862*** ] to enter system setup menu.

1. Pair
Pair with DECT base.
2. Desubscribe
Desubscribe with the DECT base.
3. Upgrade APP (Supported HTTP only)
Update system firmware (fixed by Auto Provision setting).
4. Upgrade DATA (Supported HTTP only)
Update system partition (fixed by Auto Provision setting).
5. Wi-Fi AP Scan
Scan nearby APs, select desired AP and enter password to connect.
* Press [?123] and [ABC] to switch between number and alphabet.
6. Factory Reset
Reset phone to factory default.
7. Exit
Exit system setup menu.

4. Provisioning

1. Provision config file (*.cfg)
Sample provision config file :

```
[INFO]
MODEL=VR8X00

[PROVISION]
SERVER=192.168.168.251
FILE=565

[UPGRADE]
PROTOCOL=HTTP
SERVER_IP=192.168.168.128
PORT=80
FIRMWARE=vr8x00
PARTITION=vr8x00

[NTP_SERVER]
SWITCH=1
PRIMARY_SERVER=ntp.ucsd.edu
TIMEZONE=-8:00

[ROOM_CONTROL]
SERVER=https://zenniosuite.zennio.com:34030/external/v1/zbms/rooms/
```

```
ROOM_NUMBER=102
AUTH_TOKEN=Authorization: Bearer
eyJhbGciOiJIUzI1NiIsInR5cCI6IkpXVCJ9.eyJzZXJ2aWNIX25hbWUiOiJUaWNrZXQgMjg0ODEiLCJzZXJ2aWNIX2lkjo4LCJpYXQiOiE1NzM1Njg4NDIsImV4cCI6NDcyOTMyODg0Mn0.PREQYU2QkF-7AqR91hSneDmwvyR8ToF9eH67aSnFm6c
ROOM_Type=2



[END]
SEND=END
```

After editing, save the config file name as [MAC Address] or [Room number].

MAC Address 00:11:22:33:44:55 , config file name: 001122334455.cfg.

Or Room number 1234 , config file name: 1234.cfg.

2. Provision Server IP setting

At dialing page  , press [****6861*(Server IP)#** ] .

Provision server supports TFTP (port 69) only.

For example: press [****6861*192*168*168*253#** ] to set provision server IP: 192.168.168.253



*TFTP is default protocol.

**Provision files must be under TFTP Server root directory.



3. Provision file type setting

The phone supports two file types: MAC address or Room number.



At dialing page  , press [****6862*#** ] to use MAC address type config files.

At dialing page  , press [****6862*(room number)#** ] to use Room number type config files

4. Wi-Fi Phone provisioning

After connecting to internet and setting up provision server/config file type, press [****6867*** ] at dialing page  .
Wi-Fi phone will restart and execute provisioning to complete phone settings.

5. Summary of system commands

At dialing page  , press following and  to execute commands:.

**6862*	Enter system setup menu
**6865*	Display firmware version
**6866*	Display DECT version
**6867*	Retrieve AEI tool UDP config
**6868*	Restart phone set
**6862*#	Auto provision use MAC Address config file type
**6862*888#	Auto provision use 888 room number config file type
**6861*192*168*168*253#	Set provision server IP to 192.168.168.253

6. Operations

Answering a Call

An incoming call is indicated by a ringing tone. You can answer the call by doing one of the followings:

- Press the **Dial** key on the handset to answer the call.

Making a Call

Press **Dial** key  for numerical keypad.

- Press to enter the telephone number with green dial key  to make a call..

Using the service function

To use the pre-assigned service function for the most commonly dialed numbers. Use the function to dial a number quickly, instead of keying in a complete number.

- Press **Service** key. 
- Tap the icon to call desired service.

Using the Speaker Phone

- While talking on the phone, press the **SPEAKER** key  on the phone fo hands free conversation.

Charging the Handset Battery

You would need to charge the handset battery before using the handset.

- Install the battery into the handset.
- Place the handset onto the base unit and base unit will start to charge the handset automatically.
- This icon  will show charging progress.

7. Support

For technological support, please email to support@aeicommunication.com.