



VX-3X08-BU(S)



VX-3108-BU(S), VX-3208-BU(S) User Guide

v1.1

1. Overview

This phone is a full-feature telephone that provides voice communication. Read this user guide carefully to learn how to operate this product and take advantage of its features.

Package Contents

When unpacking the device, ensure all the following items are present and undamaged. If anything appears to be missing or broken, contact your dealer for a replacement.

1. **VX-3108-BU(S) or VX-3208-BU(S) Wi-Fi Handset phone**
2. **Charging Stand**
3. **Battery**
4. **AC/DC Adaptor**
5. **User Guide (This document)**

2. Product Description

The following contains important information to help you familiarize with the functions of the phone.

Front View



Name	Description
Display screen	Display calls and status information.
SELECT SERVICES key	Press to enter scrollable guest services
Right / Left key	Press to select guest service.
LINE 1 / LINE 2 / LINE	Line key(S) to make a call or answer a call.
END key	Press to end the phone call.
Alphanumeric keys	Press these keys to enter phone numbers.
Function keys	

Name	Description
HOLD (2 line only)	Press to put an active call on hold.
MUTE (single line only)	Press to mute MIC.
<i>i</i>	Press to access dialing instructions.
VOLUME	Press to increase or decrease the volume of the ringer tone, handset, or the volume of the current call.
MESSAGE	Press to listen to voice messages.
GUEST SERVICES	Press to contact guest services.
EMERGENCY	Press to make an emergency call.

Charging stand rear view

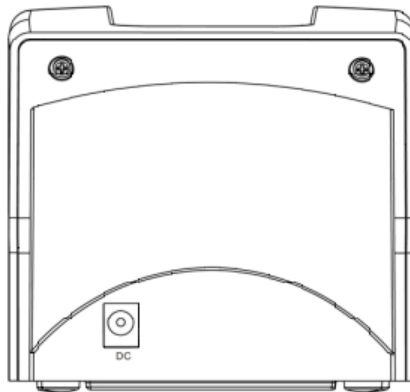

Charging stand side view

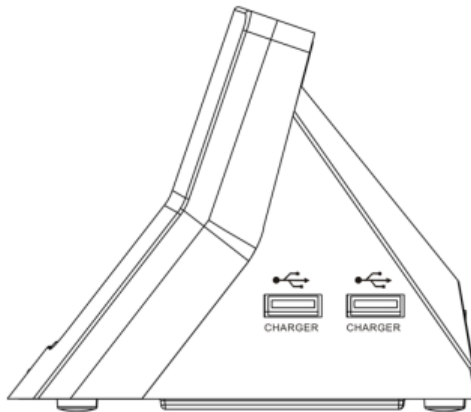

Name	Description
USB Charger port	Connects to mobile equipment charging cable.

Battery Installation

The following illustration shows how to install the handset and battery.

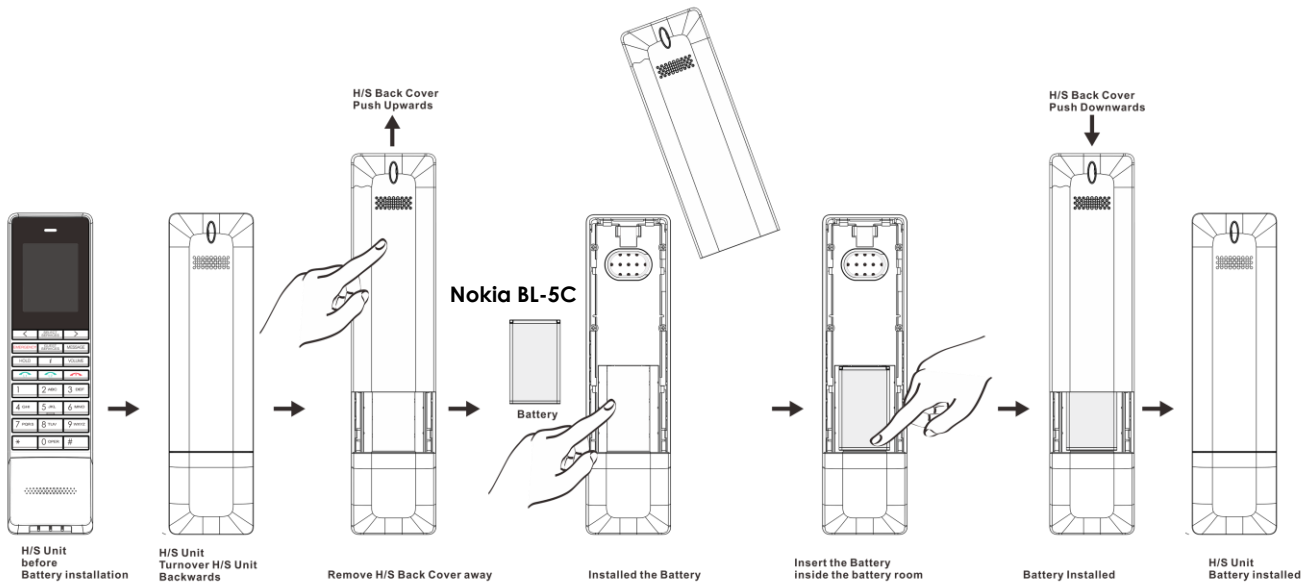

3. Web Configuration

Web Login

To setup the VX-3x08 handset from web configuration manually, boot the handset to the AP mode. Please remove the phone battery, press and hold the red button , and then reinstall the battery. The VX-3208 handset will startup and display its AP mode SSID, Password and AP IP address. Please use your laptop to connect the VX-3208 AP and then connect the phone at <http://192.168.4.1:8000> via a web browser by using username/password as admin/1234.

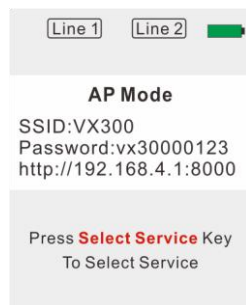

After logging in, the system information shows as below.

System Status	
Status	FW Version : FW:v0.0.2 FS:00.0.03
WIFI	WIFI SSID : FAE-rk
VoIP	Provision IP: 192.168.1.100
Speed Dial	Provision File: .cfg
System	Upgrade IP: http://192.168.168.128:69
	Upgrade FILE: vx300.vb aeiui.vi

WIFI

Setup the Wi-Fi SSID, Password and the IP type.

WIFI Setup	
WIFI SSID :	<input type="text" value="FAE"/>
WIFI PASSWORD:	<input type="text" value="1234567890"/>
WIFI IP Type:	<input type="text" value="DHCP"/>
<input type="button" value="Submit"/>	

WIFI SSID:

The WIFI SSID

WIFI PASSWORD:

The WIFI Password

WIFI IP Type:

Default is DHCP.

VoIP

Setup the SIP account

VoIP Setup	
Status	Switch : <input type="text" value="Enable"/>
WIFI	Display name : <input type="text" value="1361"/>
VoIP	User name : <input type="text" value="1361"/>
Speed Dial	Authentication Name : <input type="text" value="1361"/>
System	Password : <input type="text" value="1361"/>
	Register Domain : <input type="text" value="192.168.168.249"/>
	Register IP : <input type="text" value="192.168.168.249:5060"/>
	Register Backup Domain : <input type="text"/>
	Register Backup IP : <input type="text"/>
	First Codec : <input type="text" value="G.711 U"/>
	Second Codec : <input type="text" value="G.711 A"/>
	Frame Size : <input type="text" value="20 ms"/>
	2833 Payload : <input type="text" value="101"/>
	SIP Local Port : <input type="text" value="5060"/>
	RTP Port : <input type="text" value="42000"/>
	Expire : <input type="text" value="300"/>
	MWI : <input type="text" value="Disable"/>
	DNS SRV : <input type="text" value="Disable"/>
	Keep Alive : <input type="text" value="Disable"/>
	DTMF Type : <input type="text" value="RFC 2833"/>
	Caller ID : <input type="text" value="Disable"/>
<input type="button" value="Submit"/>	

Switch:

Check "Enable" to enable SIP registration or "Disable" to disable the SIP account temporarily.

Display Name:

Display Name is the name of the phone or the location of the phone on the remote party.

User name:

User name of the SIP account, also known as user ID or extension number.

Authentication Name:

Authentication Name is for SIP authentication.

Password:

Password of the SIP account

Register Domain:

FQDN, SIP domain name or IP address of the SIP server

For example, voip.aeicomunications.com or 172.8.12.11

Register IP:

IP address of the SIP Server

If the listening port of the SIP Server is different from 5060, please add the port to at end of address. Ex 172.8.12.11:5061

Register Backup Domain:

IP address of the secondary SIP server

For example, 172.8.12.12

Register Backup IP:

IP address of the secondary SIP Server

For example, 172.8.12.12

Codec Priority:

Select the 2 codec priority.

Frame Size:

Frame size for G711u and G711a.

G711 ranges from 20ms and 40ms.

2833 Payload: (Default, 101)

DTMF RFC2833 Payload Type, ranging from 96 ~ 127

SIP Local Port: (Default, 5060)

SIP Local port

RTP Port Base: (Default, 42000)

The port of RTP starts

Expire: (Default, 600)

SIP registration expire time (seconds); select from 60, 120, 300 and 600

MWI: (Default, Disable)

Enable to subscribe message waiting information.

DNSSRV: (Default, Disable)

Enable DNSSRV query

Keep Alive: (Default, Disable)

Send keep alive package to keep the SIP registration from being blocked

DTMF Type: (Default, RFC 2833)

DTMF for transmitting digits, * and #; select from RFC2833, SIP Info and In Band

Caller ID: (Default, Disable)

Display the caller id of an incoming call

Speed Dial

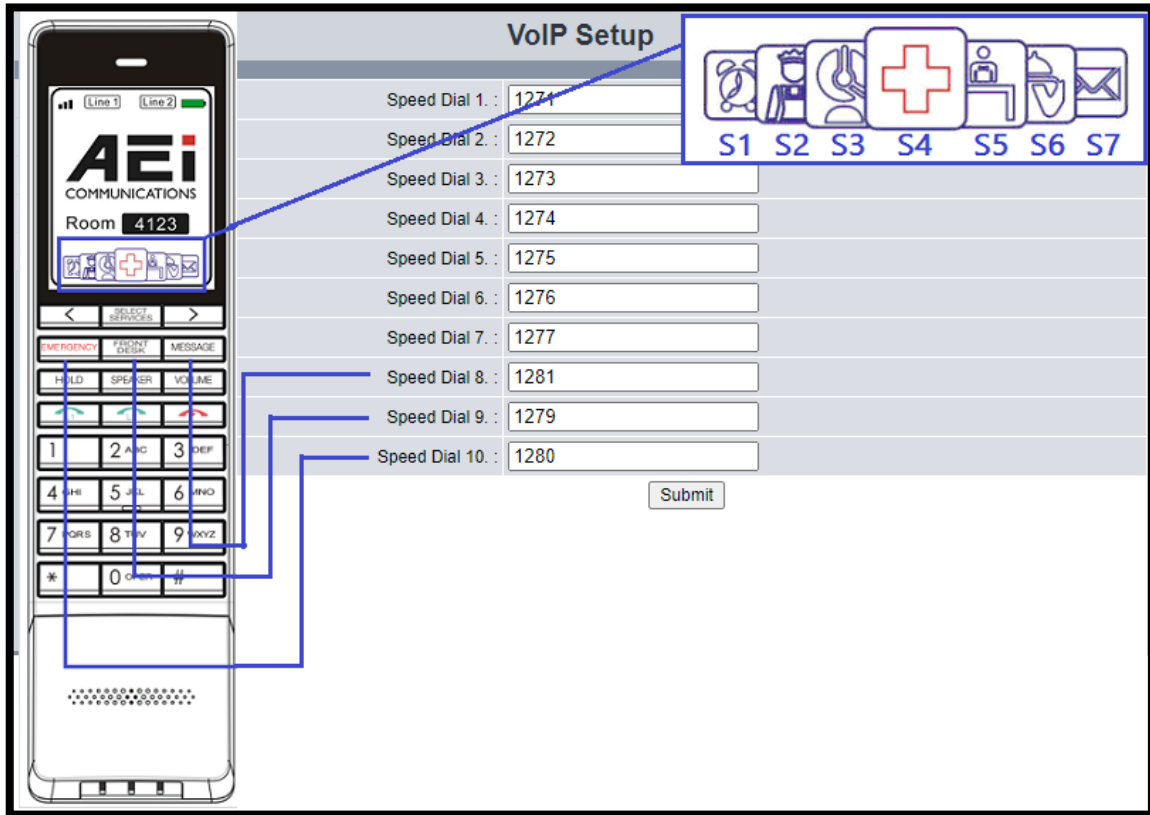

SPEED DIAL 1 ~ 7: 7 scrollable service keys.

SPEED DIAL 8 ~ 10: the physical hard service keys from left to right respectively.

System

Provision Server:	<input type="text" value="192.168.1.100"/>
Provision File:	<input type="text" value="1234"/>
Upgrade Protocol:	<input type="text" value="TFTP"/>
Upgrade Server:	<input type="text" value="192.168.1.100"/>
Firmware:	<input type="text" value="vx300.vb"/>
Partition:	<input type="text" value="vx300.vi"/>
<input type="button" value="Submit"/>	
Reboot :	<input type="button" value="Reboot"/>
Default :	<input type="button" value="Default"/>

Server:

The IP address information of the server, for example, 192.168.1.54. The phone will retrieve the .cfg file.

Provision File:

The name (room number) of the provision file in the root folder of the server.

Ex.1234: 1234.cfg

Empty MAC.cfg

Upgrade Protocol: (Default, TFTP)

Select the firmware upgrade protocol, TFTP or HTTP.

Firmware:

The file name of the firmware in the root folder of the server

Partition:

The file name of the UI package in the root folder of the server

Reboot:

Click "Reboot" to restart the phone.

Default:

Click "Default" to reset phone to factory default.

4. Quick commands

Enable AP mode:

Remove the battery. Press and hold the red button , and then reinstall battery

Set the TFTP Provision Server IP:

Ex. 192.168.5.2

**6861*192*168*5*2# Green-key (Line 1)

Update phone setting (provisioning) via room number:

Ex. Room number 888

**6862*888# Green-key (Line 1)

Update phone setting (provisioning) via MAC:

**6862*# Green-key (Line 1)

Engineering setup menu:

**6863*#

- **Reboot**

To restart the phone.

- **Init Sync**

To sync the phone settings (WIFI SSID, WIFI password, provision server) from other configured phones

Step1: Configure the 1st phone from web interface: WIFI setting, provision server and make sure the 1st phone is able to connect to the WIFI AP and download configuration file.

Step2: Remove the battery of 1st phone, press and hold the red button , and then reinstall the battery. The 1st phone will boot to AP mode and display the AP mode SSID, Password and its IP address.

Step3: Press **6863*# and select **Init Sync** on the 2nd phone. The 2nd phone will auto connect to the 1st phone and sync the WIFI SSID, WIFI password, provision server from the 1st phone .

Step4: Reboot the 2nd phone. The 2nd phone will connect to the WIFI AP and download provision file.

- **SystemInfo**
To display the MAC information and WIFI status.
- **ProvisionInfo**
To display the provision information.
- **SIPInfo**
To display the SIP account information.
- **Factory Rest**
To reset phone to factory default.
- **Firmware Upgrade**
To upgrade the phone firmware.
- **Parturition Upgrade**
To upgrade the phone User Interface.
- **Pair Mode**
To connect VX handset to other AEI Wi-Fi master phone.
- **Debug Mode**
To enable debug mode when the phone cannot register to PABX.

5. Operations

Answering a Call

An incoming call is indicated by a ringing tone and a flashing indicator at the top of handset. You can answer the call by doing the followings:

Press the **LINE (LINE1/LINE2)** key on the handset to answer the call.

Making a Call

Press **LINE** key will see all dialing description for this phone set.

You can make the call by doing one of the followings:

Dialing with the Keypad

- Enter the telephone number with the alphanumeric keypad.
- After entering the number you want to call, press the # key to force dialing or wait for 4 seconds before the number is dialed automatically.

Using the service function keys on handset



Use the pre-assigned service function to configure the most commonly dialed numbers.

To call a number using speed service dialing, follow the steps below:

- Press **SELECT SERVICES** key and use right/left key to select service.
- Press **SELECT SERVICES** key again to precede service dial.

Charging the Handset Battery

- Install the battery into the handset.
- Place the handset onto the base unit and base unit will start to charge the handset automatically.
- This icon  will show on your display during charging progress.

Checking Voice Messages

If the **message waiting indicator** at top of handset lights up in red, it indicates that there are one or more new messages in voicemail box.

- Press the **MESSAGE** key on the phone to retrieve voice messages.

(An external ITSP or PBX must support voice message feature. And you need to set a voice message code before using the voice mail feature.)

6. Support

For further technological support, please email to support@aeicommunication.com.

Record of Revision

Date	ver.	Description
2022/6/14	1.0	First issue
2022/9/14	1.1	Update for firmware v0.04